

Gender aspects based on anthropometric norms at the traditional house of Karampuang

Wasilah, Andi Hildayanti, Aisyah Kara

State Islamic University Alauddin, Makassar, South Sulawesi, Indonesia

wasilah@uin-alauddin.ac.id

Abstract: In the development of traditional architecture, the size of a woman's body has been used as a basis for determining the room size in a building. Existing forms of appreciation are manifested in the form of domains, functions, materials, and ornaments. Gender elements of female both in terms of body anatomy, and special spaces for women that are applied as a reflection the identity of traditional houses. One of the traditional houses that applies gender roles as the architectural philosophy is the Karampuang Traditional House located in Sinjai Regency, South Sulawesi. In the view of Islam, women hold great beauty potential from men, and have great potential for human survival on earth. The women are given a uterus to conceive, breasts for breastfeeding, and other hormones that function to support the role of women as mothers and wives, which is evidence of the high degree of a woman. This study discusses the gender roles as the basis philosophy and symbolism of the Karampuang Traditional House architecture in Islamic perspective. The analytical method used is the interpretation of descriptive analysis that refers to the rules of anthropometry in architecture. Anthropometry relates to measurements the dimensions of the human body. The field of anthropometry such as weight, position when standing, when stretching out your arms, body circumference, limb length, and so on. The results of this study are expected to show the size and proportion of space based on anthropometric principles of women's bodies, as well as the many aspects and symbols based on female are cannot be separated from the nature of women in the Islamic point of view and the history of Karampuang where the first person to build and prosper Karampuang is a woman. The use and placement of symbols on parts and ornaments of the house represent the anatomy of a woman's body. While matters relating to architectural aspects that are influenced by male are in terms of the development process which includes the procurement of materials / materials and *Maddui* rituals. Whereas aspects of ceremonial activities of male and female roles are comparable.

Keywords: Traditional architecture, gender roles, philosophy, symbolism, the nature of women, Karampuang.

1. Introduction

Anthropometry is one of proportional theory, refers to the proportional measurement and size of humans' body. Anthropometry theory initiated by Vitruvius, the architect in 1st century BC. Vitruvius proposed about the human face is $\frac{1}{10}$ of the body height, head from the chin is $\frac{1}{8}$ part of the body, the upper part of the breast to the roots of the hair is $\frac{1}{6}$ of the body, the foot length is $\frac{1}{6}$ of the body, the forearm is $\frac{1}{4}$, and the center of the human body is the navel. The human body is a circle-shaped when the body stretched, and have a square shape (as describe in figure below).

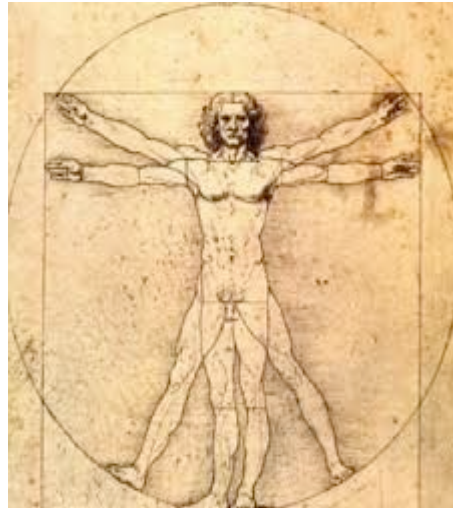

Figure 1: Leonardo da Vinci works based on Vitruvian Norm-Man (a figure in Renaissance Period)

The anthropometry method does not observe the symbolic and abstract comparison, but study the function. The method closes to the theory that state the form and the space inside the architecture could be a storage or human body extension, thus the theory determines by the size. Anthropometry is ergonomic science that study on efficiency and comfortable of a building (Ching, 2009).

Anthropometry has two categories, static anthropometry (measuring the body in static condition) and dynamic anthropometry (measuring the body in active condition). According to Purnomo (2013), there are two types of dynamic measurement, a) Measuring the skill level as the approach to understand mechanical condition of an activity, b) Measuring room range that necessary for working activity.

The principle reference in anthropometry dimension measurement may apply the gender size standard, either male or female. Male and female have different standard size. Additionally, there is a body standard categorization in Indonesia based on the existing tribes. This is the explanation for the traditional house dimension in Indonesia are diverse, because the occupant body size is different. Generally, standard body size for Indonesian people for space dimension is the male body size (head of the family). However, there is one traditional house in South Sulawesi applied anthropometry principles from the female body size (the wife). This traditional house is Karampuang traditional house, located in Sinjai Regency.

The traditional house of Karampuang is one of vernacular architecture variation that exist in South Sulawesi, located in Sinjai Regency, South Sulawesi province. A uniqueness of the Karampuang traditional house is the position of the traditional house that located in indigenous area. The area has 4.2Km² with total of road length is 5.8 Km. There are 93 houses inside the area includes *Puang To Matoa* (the kings house) and *Puang Gella* (the ministry house) (Muhannis, 2013).

Research study on the existences of Karampuang Indigenous Area is still inadequate, the previous study only examines the anthropology, legal, and social culture aspects. No much research in architecture files study for the traditional house. Therefore, references of this study is absolutely necessary for additional reference for this field study.

This traditional house develops from all stories and basic belief. The fundamental information of basic belief in any kind of culture is almost lost and most of the local people are not recognize the story, including the belief in determining the building size and overall traditional house space with anthropometry. In order to determine the size of the building, space, and etc. on Karampuang traditional house refers to human body size (anthropometry) of male/female occupant. Therefore, aim of this study is to identify and analyze the anthropometry size of male/female residents that applied on the Karampuang traditional house.

2. Research method

This study applied descriptive research method and data collection activity practiced by literature study, observation, in-dept interview, field study measurement, including recording and note-taking method to avoid data error. Focus of this study is the measurement and anthropometry practice in traditional house (*Puang To Matoa* and *Puang Gella'*). The analysis method is explorative method to reveal the fact and building size in accordance with the anthropometry principles of traditional householder (*Puang To Matoa* and *Puang Gella'*).

Additionally, there are four steps in the analysis method:

1. First step, investigating the information from informants, such as chief of *adat* or society, important figures in the society, and the local society.
2. The measurement activities on the research object are:
 - a. Linear dimension (distance): the shortest distance between two point of human body: span unit.
 - b. Body circle, circumference length: eye circle (diameter) ear circle (diameter).
 - c. Shape and body contour

Direct method with anthropometry instrument, includes: tape meter/ruler, caliper, goniometer.

3. Anthropometry principles measurement.
4. Analyzing the building size based on anthropometry principles and space philosophy of the traditional house.

3. Result and discussion

Basically, the Karampuang traditional house is a representation of woman's body shape philosophy with the ladder symbol in the center of the building and directly faced to the kitchen room. The door cover of the main ladder connected to the pulley as a control and open-close door system. The door cover symbolized as female genital, where the ladder as the pathway or the exit for baby when the baby born. The kitchen positioning is a symbol of stomach.

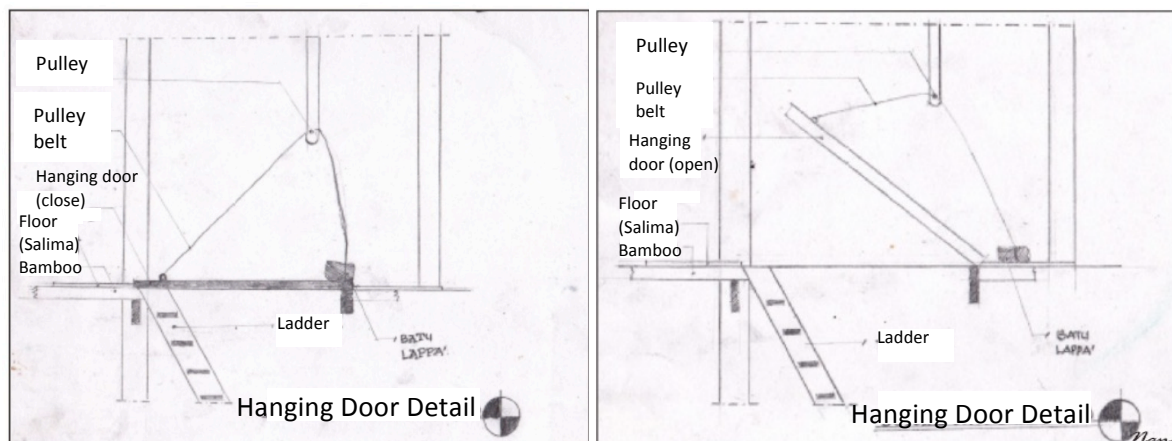

Figure 2: (a) Detail of the door in close condition; and **(b)** Detail of the door in open condition

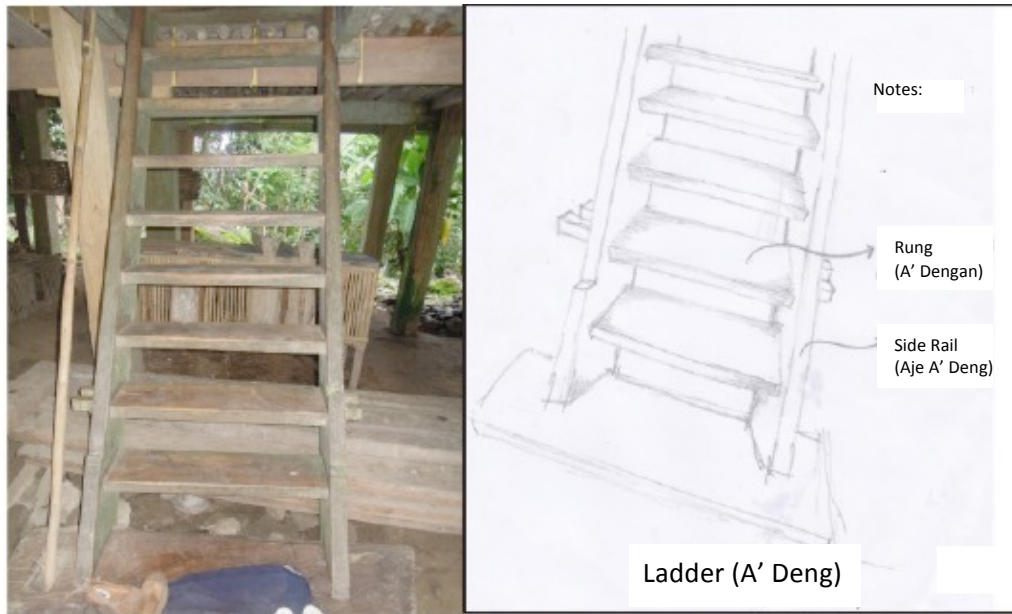

Figure 3 : Ladder detail for Karampuang traditional house

In addition, there is an ornament in one part of the house in the system of house dowel joint or *bate-bate* from wooden material, the tip of the dowel has floral ornament, as a pendent in women symbol. This ornament is located in the left and right side of Karampuang traditional house as a gender symbolization.

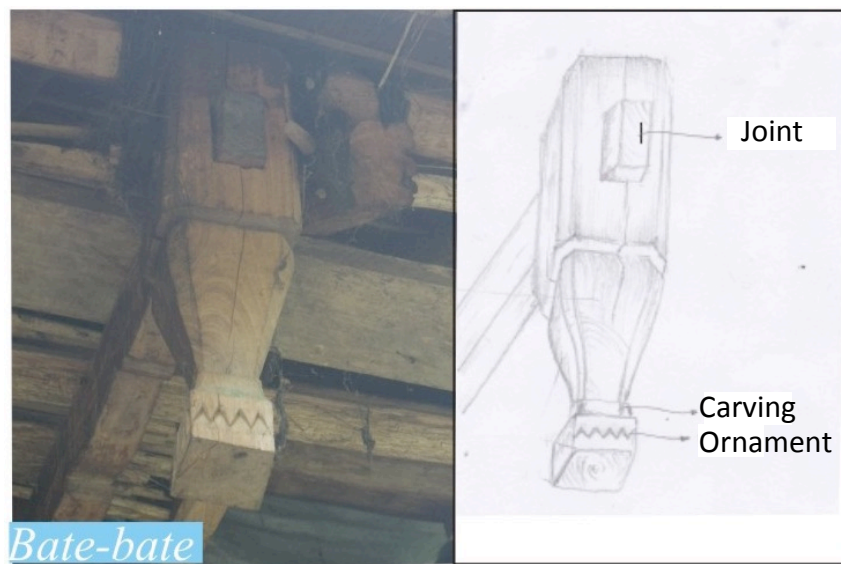

Figure 4 : Detail of *bate-bate* in Karampuang traditional house

The main building in Karampuang indigenous area has two units of the traditional houses, the king residence (*arung* or *To Matoa*) and the place to safe royal goods (*Arajang*), and the ministry residence (*Gella*). Consequently, anthropometry analysis includes *Puang To Matoa* anthropometry for *Puang To Matoa* traditional house and *Puang Gella* anthropometry for *Puang Gella* traditional house. The application of anthropometry parts are *Reppa*, *Sikku*, *Jakka*, *Kekkeng tuo*, *Lapposusu*, the height of man in standing position, the ears height when sit down, eye diameter and ears diameter.

Karampuang traditional house exists since 1760, since the Islamic teaching comes to the Karampuang indigenous area.



Figure 5 : Karampuang traditional house **(a)** Gella house (left); and **(b)** To Matoa house (right)

According to leaders of village and *Uragi*, even they not confidence on the size of *Puang To Matoa* and *Puang Gella* body size (that occupy at that time), the size of the traditional house is never changes and consistent as the original size until nowadays, even there is a material change. The material position changes will be located in initial position and the position should never changes. The effort to maintain the original size since the house existing is one of effort from the Karampuang traditional society to keep their ancestor heritage.

Based on the observation in field study, there is a different physical orientation from these two houses, house size, roof, ventilation form, and bedroom number.

1. *Puang To Matoa* traditional house
 - a. The orientation is westward
 - b. The house length is 17 *reppa + sikekkeng tuo*, width 7 *reppa + sikekkeng tuo*
 - c. The roof has three level of *timpa' laja*
 - d. four bedrooms
2. *Puang Gella* traditional house
 - a. The orientation is eastward
 - b. The house length is 11 *reppa + sikekkeng tuo*, width 5 *reppa + sikekkeng tuo*
 - c. The *Gella* roof has two level of *timpa' laja*
 - d. 2 bedrooms

A uniqueness of Karampuang traditional house observed from main ladder positioning, main entryway, and the kitchen. In contrast with others traditional houses, where the main ladder is located in front position, the door is on the same plane with the wall and the kitchen is in the backside. The main ladder of this traditional house is in the center of the house, the main door is on the same plane with the house floor, when we enter the house, we found the kitchen.

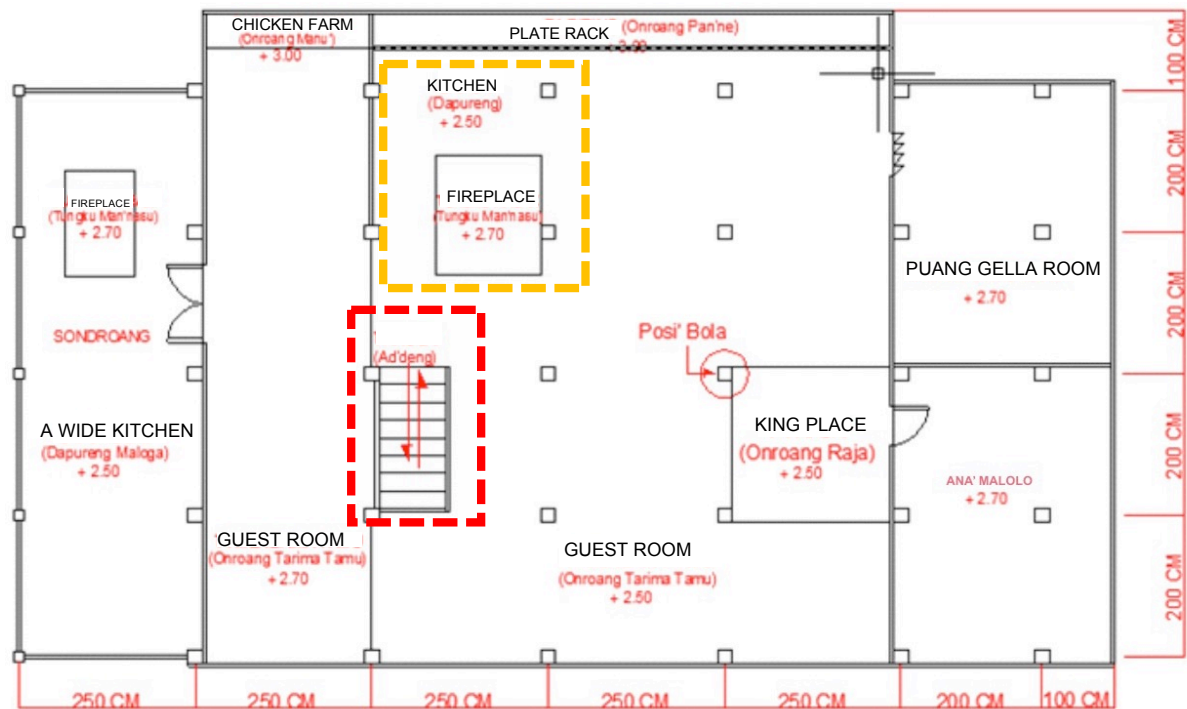





Remarks: Yellow line for kitchen positioning, red line for the main ladder positioning.

Figure 6 : Karampuang traditional house blueprint

Ladder positioning as the entryway path, a description of the female uterus position on the center of the body. The ladder is not too high because the ladder applied the female height standard. The conversion result for anthropometry size in Karampuang traditional house will explain below:

Table 1 : The anthropometry size comparison in Karampuang traditional house and the standard of Indonesian female body size and Buginese female.

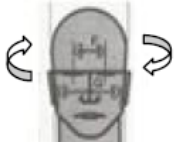
Size Category	Image	Definition	Karampuang Metric Size	Indonesian Standard	Bugisnese Standard
<i>Reppa</i>		The range size starts from the middle-right fingers tip to middle-left fingertip.	156 cm or 61.4 inches	158.5 cm	162.5 cm
<i>Lapposusu</i>		The distance between middle-right hand fingertip to the left chest.	85 cm or 33.4 inches	85 cm	86.5 cm
<i>Sikku'</i>		The distance between funny-bone to the middle finger tip.	43 cm or 16.9 inches	45 cm	44 cm
<i>Jakka'</i>		The distance measurement range between the tip of little finger to the tip of thumb.	20 cm or 7.8 inches	20 cm	20 cm

Size Category	Image	Definition	Karampuang Metric Size	Indonesian Standard	Bugisnese Standard
<i>Sikekkeng tuo</i>		The size is a handful with thumbs up.	15 cm or 5.9 inches	15 cm	15 cm
As high as eye in standing position		The altitude range is between the eye to the ground when the stand up	150 cm or 59 inches	152.5 cm	153.5 cm
As high as ear when sit down		The altitude range is between the eye to the seat	70 cm or 27.5 inches	70 cm	71 cm
Eye diameter		The size is between the right eye circled the head to the left eye	46 cm or 18.1 inches	46 cm	47 cm
Ear diameter (soli)		The distance is between the right ear circled the head to the left ear	25 cm or 9.8 inches	26 cm	28.5 cm

According to the anthropometry application analysis after conversion into metric size from the anthropometry data of Indonesian people (female) in centimeter and the anthropometry data of Bugisian people (female) in centimeter, most of the house size are not standard. The building function is the place for traditional ceremony for the local society, but no consideration in building capacity. All activity during the traditional ceremony held in *To Matoa* house, including the number of guests or tourist visitors with a hundred's participant. Consequently, the space capacity is not standard.

In contrast with *Gella house*, for meeting or discussion between *Puang Gella* and some of important figures in the society, the capacity is reasonable standard condition. Moreover, a natural illuminance aspect is not standard according to the lux standard. The window opening and ventilation in these two of Karampuang traditional house is not standard, less than one tenth of the total of house floor.

The main door in Karampuang traditional house in accordance with the normative standard and the bedroom door size and ladder is not standard. The natural ventilation of the traditional house is sufficient and cool because the ventilation hole is more than 5% then the total of house floor. In contrast with the kitchen, according to the standard size, the illuminance and air circulation standard for the kitchen room size and furnishing in Karampuang traditional house are not standard.

The measurement analysis for the room capacity requirement almost close to the occupant activity in the Karampuang traditional house kitchen, the furnishing size of the Karampuang traditional

house is not standard. User positioning for cooking activity seems difficult and not comfortable, but as the kitchen furnishing size standard in the traditional house has their own standard and meaning inside the size, then the user only adapted with current condition.

The illumination system in the Karampuang traditional house kitchen is traditional lighting equipment (oil lamp with wicks and kerosene as the fuel). This system is not standard according to kitchen condition. Even the lighting is poor, this traditional lighting equipment is flexible and easily removable in accordance with the activity to provide a lighting during cooking process and create a habit and comfort for the user during cooking activity. There is no funnel found in the Karampuang traditional house kitchen. The air circulation and kitchen smoke come out through the wall and floor that made from bamboo, ventilation, and the door before the smoke blows to another room.

Anthropometry application for the local houses of Karampuang indigenous area are different with the *To Matoa* and *Gella* traditional house. There is no *reppa* size found in the local society house, because *reppa* size is only for the traditional house. Additionally, procedure in measuring the building height proportion in the society house is different with the traditional house. This differentiate would lead a clear difference between traditional house and society house. In addition to the social stratification of head of *adat* (*Puang Matoa*, *Puang Gella'*, *Puang Sanro* and *Puang Guru*), the stratification of the Karampuang indigenous area are equal.

4. Conclusion

Anthropometry application in Karampuang traditional house such as *Reppa*, *Sikku*, *Jakka*, *Kekkeng tuo*, *Lapposusu*, the height in standing position, the height when sit down, eye diameter, and ear diameter, resulting the building length and width, door size, opening width, and ladder size that refer to anthropometry size of the owner of the house, the female (wife). The female anthropometry becomes the primary references when building the society house, and the differentiates among the others traditional houses.

The anthropometry measurement pattern, followed by space philosophy that close to the female identity as the wife or mother, is one of the ancestor heritages that should preserved. This condition followed by the local people that consistently maintain the Karampuang traditional house existences through the positioning and material size maintain when they change the material as a consequence of damage as the culture preservation action.

References

- Ching, F.D.K. (2009). *Arsitektur: Bentuk, Ruang, dan Tatahan* [Architecture: Form, Space, and Layout]. Erlangga. Jakarta.
- Ching, F.D.K. et al. (2011). *Desain Interior dengan Ilustrasi* [Interior Design with Illustration]. Indeks. Jakarta.
- Handayani, Trisakti, Sugiarti. (2002). *Konsep dan Teknik Penelitian Gender*. [Gender Research Concepts and Techniques]. UMM Press. Malang
- Harmayani. (1998). *The Oxfam Gender Training Manual*, Oxfam UK and Ireland (terjemahan)
- Moser, CON. (1993). *Gender Planning and Development : Theory, Practices and Training*. Routledge. London.
- Mosse, J.C. (1993). *Gender & Pembangunan*. [Gender and Development]. Penerjemah: Hartian Silawati, tahun 1997. Pustaka Pelajar. Yogyakarta.
- Muhannis. (2013). *Karampuang dan Bunga Rampai Sinjai*. [Karampuang and Sinjai Anthology] Ombak. Yogyakarta.
- Panero, Julius. (2003). *Dimensi Manusia dan Ruang Interior*. [Human Dimension and Interior Space]. Erlangga. Jakarta.

- Pratomo, S. (2012). Penyelesaian Sengketa Menurut Hukum Adat Pabbatang Di Karampuang, Kecamatan Bulupoddo, Kabupaten Sinjai. [Dispute Resolution based on Pabbatang Traditional Law in Karampuang, Bulupoddo District, Sinjai Regency] Unpublished undergraduate thesis. Makassar. Law Faculty – UNHAS.
- Purnomo, H. (2013). Antropometri dan Aplikasinya. [Anthropometry and the Application] Graha Ilmu. Yogyakarta.
- Rahim, Rahmiani, et al. (2014). Kaidah antropometri dalam rumah adat karampuang sinjai – provinsi sulawesi selatan. [Anthropometry Principle in Karampuang Sinjai Traditional House – South Sulawesi Province] Unpublished thesis. Makassar. UNHAS.
- Rappoport, Amos. (1977). House, Form and Culture. Pergamont. New York.
- Rappoport, Amos. (1977). Human Aspect of Urban Form. Pergamont. New York.
- Tato, S. (2009). Arsitektur Tradisional Sulawesi Selatan Pusaka Warsan Budaya Indonesia. [South Sulawesi Traditional Architecture The Heritage of Indonesian Culture] El Shaddai. Makassar.
- Wignjosebroto, S. (2008). Ergonomi, Studi Gerak dan Waktu. [Ergonomics, Motion Study and Time]. Jakarta. Guna Widya.
- Woodson, Wesley E., Tillman Barry, Tillman Peggy. (1992). Human Factors Design Handbook: Information and Guidelines for the design systems, facilities, equipment, and products for human use. Mc Graw Hill. Second Edition. New York.